

INSTALLATION INSTRUCTIONS

DESCRIPTION: MT-10 Windscreen
PART NUMBER: B5Y-F83J0-V0
MODEL: 2022+ MT-10



⚠ WARNING

Please read and understand these instructions completely before installation to avoid possible injury, or damage to the accessory or vehicle.

NOTICE:

Installation of this kit requires a torque wrench and should be performed by an authorized Yamaha dealer or a qualified mechanic.

WARRANTY INFORMATION:

In the United States, contact your dealer of purchase for information, fitment advice and a copy of the Yamaha Genuine Parts and Accessories Limited Warranty for this accessory.

DEALER OR INSTALLER:

These instructions contain important information for future reference and *must* be given to the customer.

PARTS LIST:

No.	Part Number	Description	Qty
--	B5Y-F83J0-V0	MT-10 Windscreen	--
①	*	Windscreen	1
②	*	Metal Screen	1
③	*	Mount Bracket	1
④	*	M4x6mm Button Head Screw	4
⑤	*	M4 Cap Nut	4
⑥	*	M6x35mm Button Head Bolt	3
⑦	*	M6 Spacer	3
⑧	*	M5 Well Nut	4
⑨	*	M4 Washer	4

* Part supplied with kit only and not available separately.

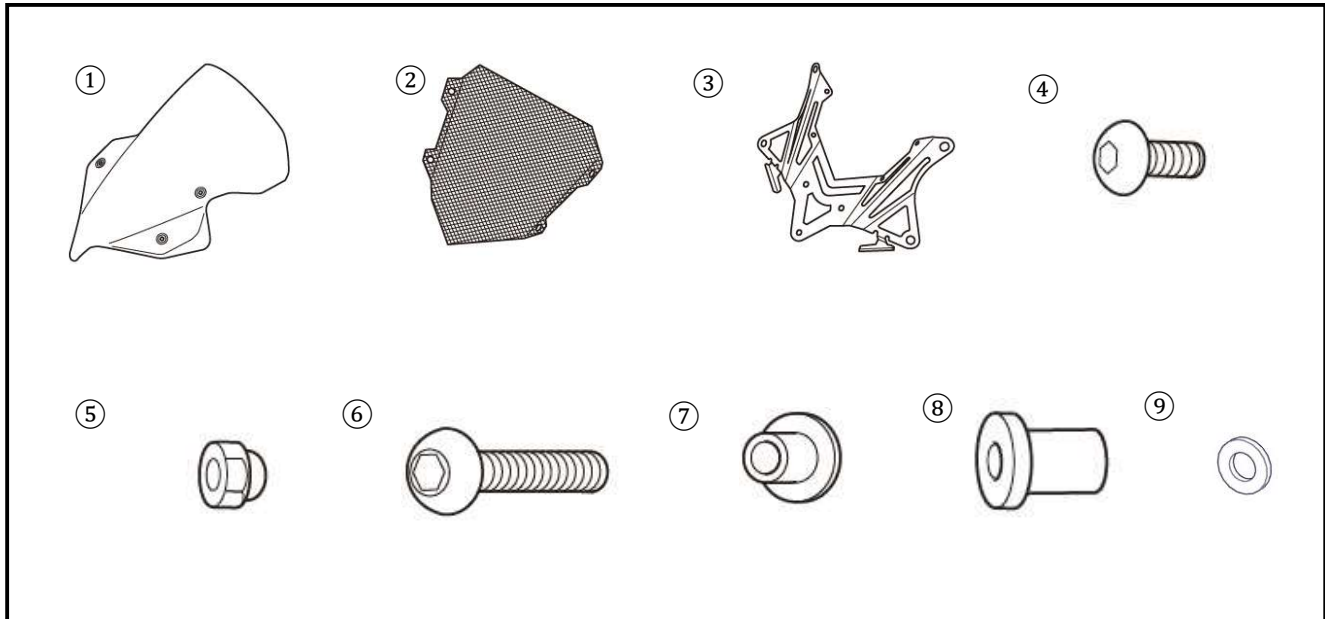
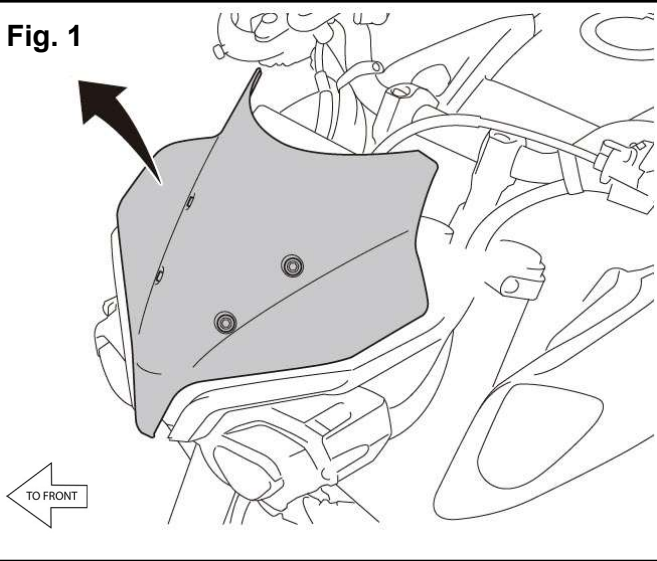

Fig. 1



PREPARATION:

- Stand the motorcycle on a secure and level surface.
- Clean the mounting surfaces before beginning installation.

INSTALLATION:

1. Remove the four stock bolts for the windscreen. Retain for reuse. Remove the stock windscreen. It will not be reused. (Fig. 1)
2. Remove the stock windscreen mount. The front dampener on the stock mount will be reused. The hardware and stock mount will not be reused. (Fig. 2)
3. Install the ② Metal Screen to the ③ Mount Bracket. Place one ⑨ M4 Washer on each ④ M4x6mm Button Head Screw. (Fig. 3)
4. Insert the ④ M4x6mm Button Head Screws through the ② Metal Screen and into the ③ Mount Bracket. This will place a slight upward curve in the ② Metal Screen as you install it. (Fig. 3)
5. Thread on the four ⑤ M4 Cap Nuts and torque the ④ M4x6mm Button Head Screws to 2Nm (17.7 in-lbs.). (Fig. 3)
6. Install the three ⑥ M6x35mm Button Head Bolts through the lower holes on the ③ Mount Bracket. Place the three ⑦ M6 Spacers on the ⑥ M6x35mm Button Head Bolts with the flanged ends downward. (Fig. 3)
7. Align the ③ Mount Bracket with the stock location of the original windscreen. Thread in the ⑥ M6x35mm Button Head Bolts and torque to 2.5Nm (22.1 in-lbs.). (Fig. 3)

Fig. 2

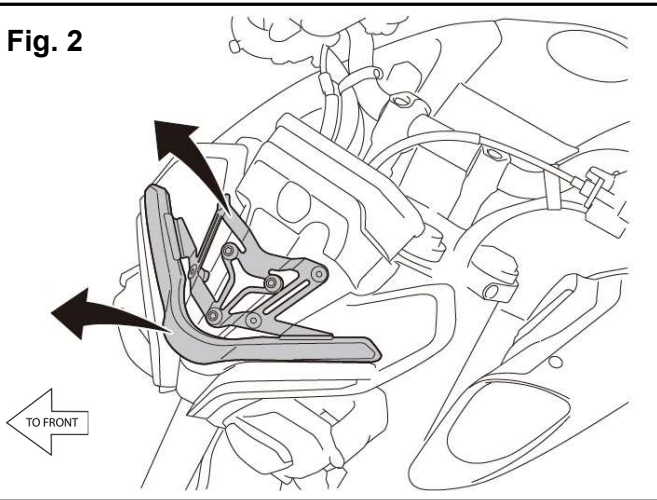
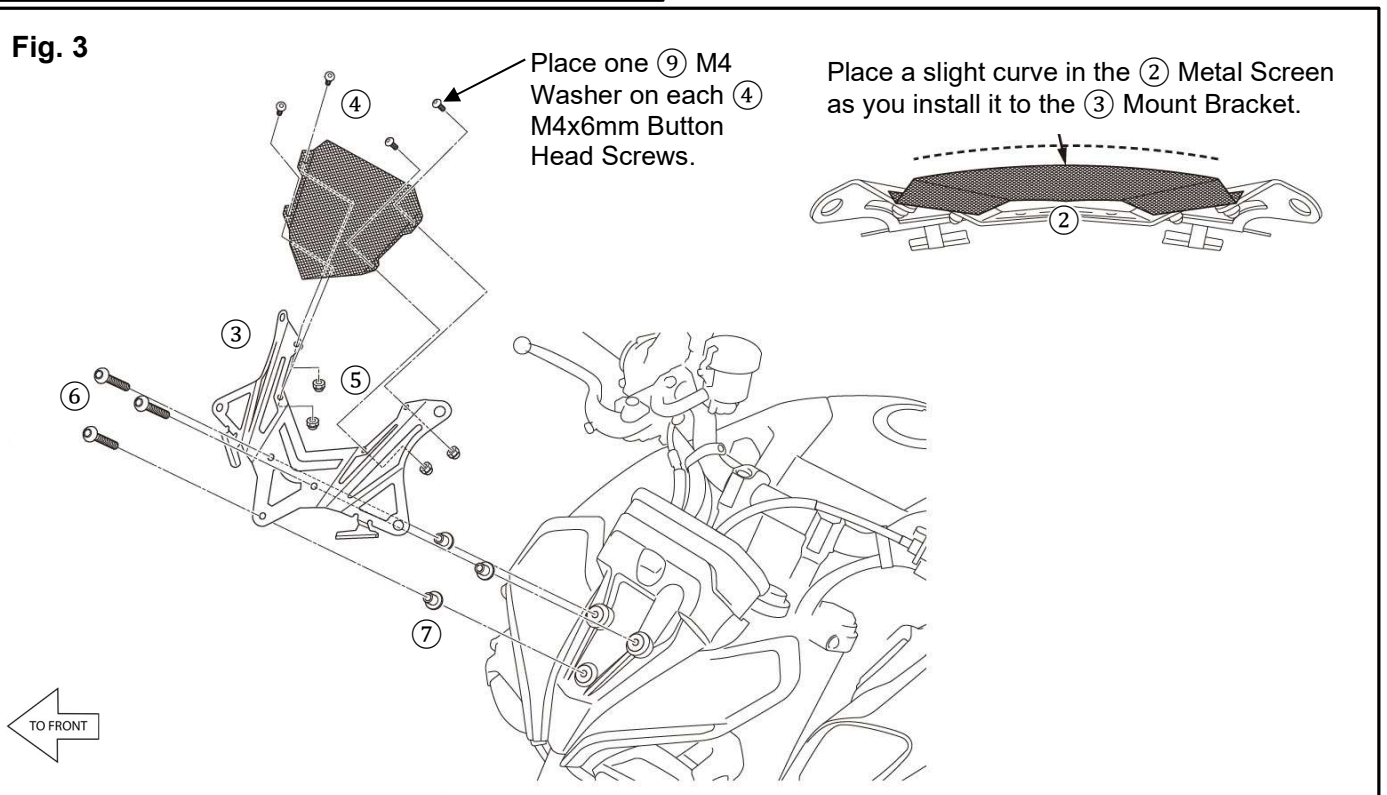
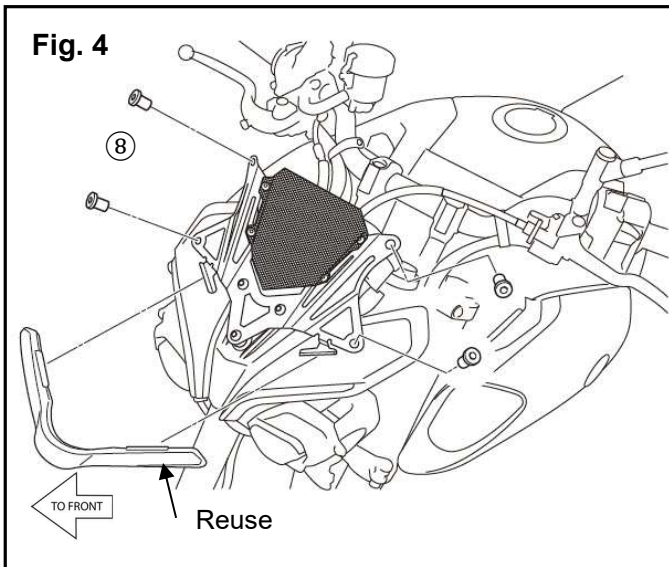
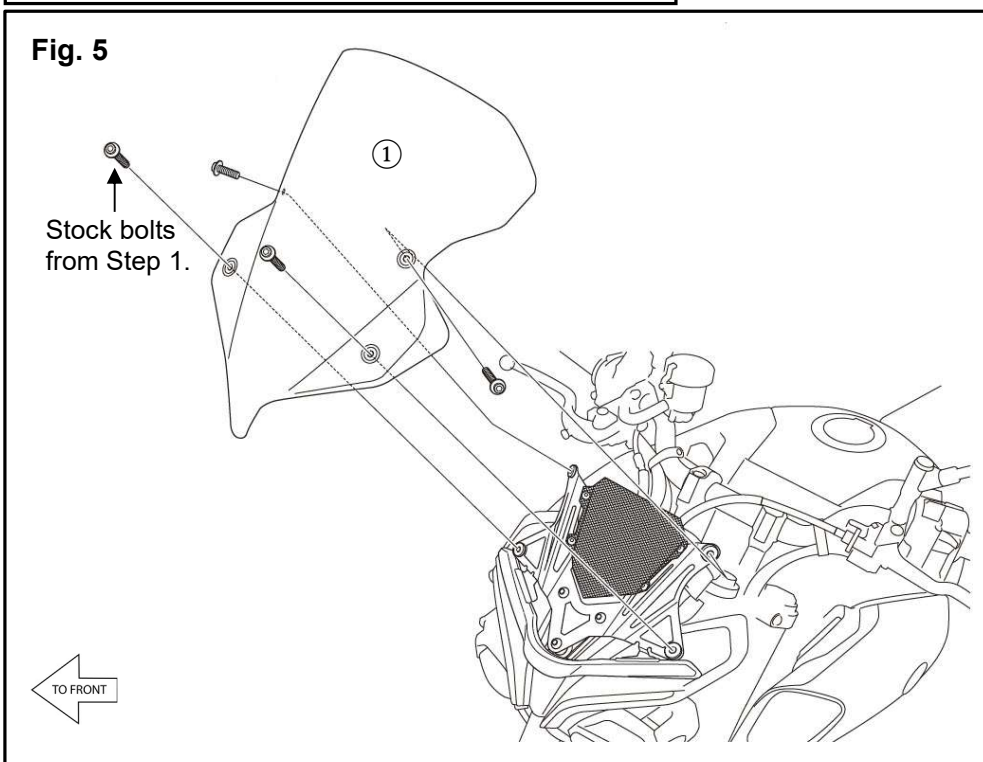

Fig. 3





8. Attach the stock dampener to the front of the ③ Mount Bracket. (Fig. 4)
9. Insert the four ⑧ M5 Well Nuts into the ③ Mount Bracket at each outer hole. (Fig. 4)
10. Align the ① Windscreen mounting holes over the ⑧ M5 Well Nuts. Thread in the stock bolts saved from Step 1. Torque to 0.5 Nm (4.4 in-lbs.) (Fig. 5)



MAINTENANCE:

Periodically, check the tightness of all hardware and retighten as necessary.

CARE AND CLEANING:

Wash using a mild soap and water solution and a soft cloth. Use Yamalube® Windshield & Visor Plastic Cleaner & Conditioner (p/n ACC-PLASP-OL-11) or other high-quality plastic cleaner when needed.

CUSTOMER SERVICE:

For further information see your Yamaha dealer.

ESTIMATED TIME TO INSTALL: 0.3 HRS.